

# Maiden Bradley Parish News

377 November 2020



# November Diary

1	Sun	<i>Benefice Service, All Saints'</i>	10am
2	Mon	<b>Green Bin Collection</b>	
4	Wed	<b>Recycling Collections</b>	
8	Sun	<i>Remembrance Service</i>	10.45am
<i>Book places with Sarah Neish: sarah.neish@hotmail.co.uk,</i>			
<i>Text: 07708035444 or phone 844689</i>			
9	Mon	<b>Household Waste Collection</b>	
10	Tues	<b>Parish Council Meeting by Zoom</b>	7pm
15	Sun	<i>Morning Service with Guest Speaker</i>	10am
16	Mon	<b>Green Bin Collection</b>	
18	Wed	<b>Recycling Collections</b>	
20	Fri	<b>COPY DATE to pat@visa-office.com</b>	
22	Sun	<i>Holy Communion</i>	10am
23	Mon	<b>Household Waste collection</b>	
29	Sun	<i>Parish Communion</i>	10am
30	Mon	<b>Green Bin Collection</b>	

## Useful Telephone Numbers

Speed Watch Co-ordinator	Simon Wager	simon.m.wager@gmail.com
Community Garden	Kate Moore	katemore@silkmillstudios.co.uk 01985 844305
Book Club	Jessica Johnson	01985 844174
Pilates		01985 511693
Cookery Demonstrations	Rosie Brown	01985 844236
Luncheon Club		01985 844779
Welcome Club Outings		01985 844779
Scrabble Club		01985 844919
Memorial Hall bookings		01985 845303
Dr Andrew Murrison MP		01225 358584
	murrisona@parliament.uk	
Mere Link Scheme		01747 860096
Rev. Carol Wilson-Barker		01747 861859



The shop is open in the Village Hall on Mon, Wed and Fridays 9-11.30am

The post office is open in the Village Hall on Tuesdays 1-3pm

Bell Ringing Tuesday 7 pm in the Bell Tower at the Church, beginners welcome 844475

Coffee Mornings every Friday in the Hall 10 am till 12 noon

Maiden Bradley Parish News – contributions are preferred in editable text format.

Email pat@visa-office.com

**Magazine available online on the village website:**

**[www.maidenbradleyvillage.org.uk](http://www.maidenbradleyvillage.org.uk)**

# Editorial

The News Team would like to extend a huge THANK YOU to everyone who has supported our appeal for funds towards the printing costs of the magazine. From the messages of support received it is clear that the monthly Maiden Bradley Parish News is highly valued along with the effort that the Team provide to produce it. Thank you.

There is lots of interest in this month's edition, and I am particularly interested in the now annual Christmas Wreath making event on 5<sup>th</sup> December. Know of any good walks? Let Alex Channer know about them. Kate has a great idea for collecting and planting seeds -see the Greener article.

Pat Kennedy 845397 [pat@visa-office.com](mailto:pat@visa-office.com)

# THANK you For £740

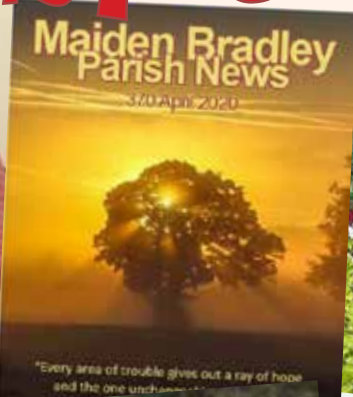

## NEWS FROM THE HALL

Hope you are all keeping as safe and well as possible. During these difficult times there is little news to report.

Hard to believe that a year ago we were getting excited about welcoming the BBC at the end of November for the filming of "Countryfile"!

We will be holding a Christmas raffle and tickets will be on sale in the shop. If anyone would like to donate a prize, they would be gratefully received. Mary Stevens is the organiser.

The draw will be made on Monday 21st December and prizes can be collected during shop opening hours 9 - 11.30am on Wednesday 23rd.

Don't worry, there will be a reminder in the December Parish News!

There will also be a rather special Christmas decoration competition, - full details in the centre spread of this month's magazine

Best wishes,

*Pam Thomlinson*

### **New Chairs - Appeal Update**

Well, clearly there hasn't been much requirement for 'sitting comfortably' in the Hall this year! But do not fear - your generous donations haven't been forgotten - and we will be purchasing the chairs in the New Year.

We have raised £680 so far -

## **Thank you!**



### LIFE DURING LOCKDOWN.....

As I have only had a limited number of contributions, I have decided to collate them all and put in a folder that can be read in the Memorial Hall, as from the end of October. This will be a record of Life during Lockdown in Maiden Bradley.

*Rosie Brown*

# GREEN MAN



**Professional,  
Eco-friendly  
Carpet, Hard Floor,  
Rug & Upholstery  
Cleaning**

**FROME: 01373 470416**



MEMBER 3007

**[www.greenmancleaning.co.uk](http://www.greenmancleaning.co.uk)**

 Follow 'Fostering in Wiltshire'

*Could you offer a stable  
and supportive home?*

We need foster carers who can provide a loving, supportive home for children in care. We will provide you with suitable placements to match your circumstances. You will be part of a professional team and be provided with your own support worker, ongoing training and a 24 hour helpline. In addition, you will be paid a generous allowance.

**Interested?**

Call us today on 0800 169 6321,  
email [fostering@wiltshire.gov.uk](mailto:fostering@wiltshire.gov.uk) or  
go to [www.wiltshire.gov.uk/fostering](http://www.wiltshire.gov.uk/fostering)

*Be the difference – become a foster carer with Wiltshire Council*

**Fostering**  
be the difference

**Wiltshire Council**  
Where everybody matters

## Church News

A few of us (very limited numbers because of the virus) had a fascinating visit to Wimborne to see the William Monk clock this afternoon. It was working and it was most interesting to see a handmade clock that is centuries old and to observe how it could strike the hours. We are indeed fortunate that after servicing it will be returning to the church; it is in remarkably good condition for its age.

Due to the coronavirus restrictions there will be no singing at the Remembrance Sunday service this year and in order for it to be socially distanced it would help if places were booked. Details on how to book a place by contacting Sarah Neish can be found on the back cover of this magazine.

*Celia Blay*

### Poppy Appeal 2020

The world so many knew had been turned upside down by the Second World War, and the end of the war, 75 years ago did not mean the end of the service or sacrifice for so many - 3.8 million British men and 400,000 women were demobilised, returning to their homes and families, some for the first time in many years.

Many of the feelings, emotions, and challenges faced by the Second World War generation, while different in their causes and extent, have echoes for many today; shortages of goods, feeling socially isolated, familial dislocation, a sense of the unknown, a feeling of being forgotten, and the collaboration of nations and communities to face a common foe. And as the entire nation relied on our service personnel and public servants then, so we do again today.

Many of us will in Maiden Bradley have personal connections with those who served Queen and Country. It is our opportunity to remember the service and sacrifice made by so many peoples, communities and nations, 75 years ago and we reflect on the service and sacrifice of so many today.

Covid 19 is inevitably affecting the way in which the Poppy Collection will be carried out this year. There will be poppies on sale in the village shop and hall, but the usual house to house collections will not take place this year. There will be a collection for the Royal British Legion in church on Remembrance Sunday.

*Sarah Neish*

### Remembrance

Mel Thomas will be laying

a wreath at the memorial bench on Wednesday 11th November at 11.00 am.

If anyone wishes to attend would they please arrive by 10.50 am.

Social distancing to be observed.



## Elizabeth Gittoes

Registered  
Osteopath



Consultation by prior arrangement. Please call Elizabeth to make an appointment.

Email: [lizgittoes@yahoo.co.uk](mailto:lizgittoes@yahoo.co.uk)

Telephone: 01747 840496

The Old Police House  
Stourton, BA12 6QG.

## INTERIOR PAINTER & DECORATOR

20+ YEARS EXPERIENCE

Kaaren Arenka

Mobile: 07707 156 498

Email: [kaaren.arenka@gmail.com](mailto:kaaren.arenka@gmail.com)



Tailored Lettings &  
Property Management  
Residential Sales

Mere - 01747 356176

Maiden Bradley - 01985 844972

Anne Freeman

Local, Reputable, Honest & Approachable

Free No Obligation Valuations

[amuletresidential@gmail.com](mailto:amuletresidential@gmail.com)

Find us on Facebook

[www.onthemarket.com](http://www.onthemarket.com)

## ALLSOP CARPETS & FLOORING

DOMESTIC ♦ COMMERCIAL ♦ INDUSTRIAL

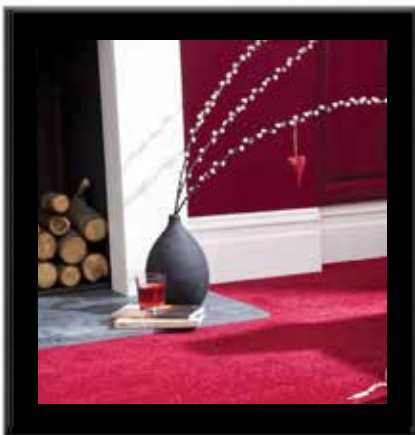

Christchurch Street West, Frome. BA11 1EB

TEL: 01373 463866  
MOBILE: 07887 953014

[www.allsopcarpets.co.uk](http://www.allsopcarpets.co.uk)

# Harvest Festival

Celia Blay writes:

“We raised £125 for the Foodbank and collected far more bags and boxes full of food than usual.”

So, our thanks go to Celia for her work in the community and helping to generate the interest in giving, especially at this difficult time during the Covid 19 pandemic.

The food and money goes to the Warminster and District Food Bank.

*And thanks of course to Sue Priestner and all the flower arrangers for the wonderful harvest festival displays*







# Computing@home

Computer support and training run specifically for home users.

Available remotely or in person Ideal for anyone without IT experts easily on hand.

IT terrified to advanced - silver surfers a specialty.

Contact Nigel on:

[www.computing-at-home.co.uk](http://www.computing-at-home.co.uk)

01985 844637



**Garston**  
Veterinary Group



## Laser therapy

Laser therapy is a non-invasive treatment using specific wavelengths of light (red and near-infrared) to create therapeutic effects which can improve wound healing time, pain reduction, increased circulation and decreased swelling.

We are offering **10% off** Laser Therapy treatments during March & April.

Laser Therapy Treatment sessions are held at our Warminster and Trowbridge surgeries.  
Please contact your usual surgery to make arrangements.

Frome	Melksham	Trowbridge	Warminster	Westbury
01373 452225	01225 617779	01225 754021	01985 213350	01373 301448



[www.garstonvets.co.uk](http://www.garstonvets.co.uk)



## TREES

Despite all the technological advances that exist, no-one has yet invested a better way to sequester (suck) carbon out of the atmosphere than the tree.

The brilliant team at 2 Minute Foundation (the charity behind 2 Minute Beach Clean) are crowdsourcing a forest and they need our help!



### How?

Here's what you need to do:

- Ferret through the recycling bin for some old loo rolls.
- Collect at least 20 native seeds eg, conkers, acorns, beech masts and ash 'helicopters'. I found all but two of mine in Back Lane.
- Pop some soil or peat free compost into the loo rolls and plant a seed in each & keep them outdoors, moist & in a sunny spot.
- Wait. Hopefully at least some will germinate
- Next year there will be a planting party and we can find places to pop the yearlings into the ground!

## CHRISTMAS

Some of you super organised people may already be busy with Christmas wrapping etc. Next month there will be more about how we can minimise the damage to the environment from this bonkers bumper bash! But for now here is a scary fact:

227,000 miles of wrapping paper is used each Christmas in the UK alone - that's enough to go round the globe 9 times!

Much of it is not even paper. So if you do decide to wrap things before midnight on 24th December think about whether you need to go out and buy that shiny flexible plastic that is calling itself wrapping paper, or whether you need to use wrapping paper at all. How about taking the staples out of this very publication and wrapping something in it?

Please send ideas and pictures to [katemoore@silkmillstudios.co.uk](mailto:katemoore@silkmillstudios.co.uk) or ring 844305



**CHRISTMAS  
WREATH-MAKING  
AND MINCE PIES**

**Saturday 5th December**

**10.00 - 12.00 Village Hall**

**Maiden Bradley**

**PLEASE JOIN US TO MAKE YOUR HOMEMADE CHRISTMAS WREATH TOGETHER,  
EAT MINCE PIES, HAVE A CUP OF TEA OR COFFEE, OR MULLED WINE, AND GET  
INTO THE CHRISTMAS SPIRIT!**

Recommended materials to bring to make your home-made wreath:

- Wire coat hangers for the frame (or buy a metal wreath frame online)
- Bring wire so you can attach decoration to the wreath
- Secateurs/scissors for cutting
- Evergreens, fir cones, moss, ivy, berries to decorate
- Christmas ribbon, Christmas balls, material etc. to decorate

Donations to the hall gratefully received

Please email Alex Channer ([adrchanner@gmail.com](mailto:adrchanner@gmail.com)) or let Sheila Foley know if you plan to come.

*Tables will be set up to enable social distance and hand sanitizer will be available.*



Rural Business Services was established in 1997 to provide professional book-keeping and administration services for small to medium sized rural based businesses. In addition we offer first class Project Management, sound sensible Business Administration & Financial Solutions together with Board Level Financial Management Experience. No matter how small or big your requirement is we can tailor support to suit your business needs either on or off site.

For more information or to discuss your requirements contact  
Lucinda Stokes on 01985 844017  
[www.ruralaffairs.co.uk](http://www.ruralaffairs.co.uk) • email: [lucinda@ruralaffairs.co.uk](mailto:lucinda@ruralaffairs.co.uk)

# LET'S BRING SOME JOY TO THE VILLAGE THIS CHRISTMAS!

We would like as many people as possible to decorate the exterior of their house this year. It could be the whole frontage, the window - or just the door, but let's all do something to make our village really shine!

There is also the chance to win one of three Christmas hampers which will be awarded as prizes for the 'Best Decorated House' in the opinion of international light artist, Bruce Munro.

Many of us have enjoyed Bruce's installation to support the NHS 'Ribbon of Light' on Long Knoll

Entry to the competition costs £5.  
All money raised will go towards the  
upkeep of the memorial hall

**MAIDEN BRADLEY  
CHRISTMAS DECORATION  
COMPETITION  
ENTRY FORM**

I WISH TO ENTER THE FOLLOWING ADDRESS:

NAME AND PHONE NUMBER:

I enclose £5 entry fee  
which will be used towards  
the upkeep of the Memorial Hall

Please return this form and cash / cheque  
to one of the following:

**The Village Shop  
Old School Cottage High St  
31 Church Street**

## HOW TO ENTER

Return the completed entry form along with £5 to either  
the shop in the hall (Mon Weds or Friday mornings)  
or drop through the letter box of  
The Old School Cottage, High St (Sheila Foley)  
or 31 Church St (Elaine Lavender)  
**Closing date December 14th.**

## JUDGING

Bruce Munro will be judging the entries  
on 23rd of December and awarding a 1st, 2nd and 3rd  
prize for what he considers to be the most attractive  
festive decoration.

This could be a whole house, window or maybe just a  
door wreath.

Quantity is not necessarily quality!  
The hamper prizes will include a copy of  
Bruce's book and DVD  
as well as a selection of festive goodies.

The judge's decision is final

## THE VILLAGER'S VOTE

This is a chance for everyone to cast their vote!  
Which is your favourite decoration in the whole of the village?  
You can vote for **any** house, window or door -  
not just the competition entrants.

Fill out the information below and drop this page into the  
Village Hall mailbox between the 14th and 23rd of December.

My favourite decoration was at the  
following address:

Votes will be counted on December 23rd  
There is no additional prize for the winner of the Villagers' Vote  
but it will be featured in the January Newsletter



# VanVenture

2020  
(part 1)

Mark Lucas-Phillips



We bought 'Jonny', our new Motorhome following the strange times of Covid and a desire to both holiday and adventure, something that was a challenge given the current pandemic. A Motorhome had always been our retirement plan but recent changes in circumstances and the Covid situation had made me ever more resolute to make our choices now and put nothing off. Life is, after all for living and the constraints of social distancing seemed to really fit the flexibility and independence that a fully contained living space on wheels can bring. We had originally planned to take the Eurotunnel into France and chase the sun down to the Med but with increased nervousness about a potential quarantine period and a slower than usual Passport renewal service we shelved this plan and reverted to plan B; a mini tour of the UK for 2 weeks in August, including Wales, the Lake District and Scotland. Those who know me well would note these destinations all have one thing in common, Mountains, hills and generally high places! So it should have come as no surprise to my family that with this roadmap in mind a challenge would shortly follow. So, the 5 of us and Archie, our faithful, yet lazy West Highland Terrier set off in 'Jonny Urge' to climb 4 Peaks; Pen Y Fan, Snowdon, Scafell Pike and Ben Nevis, oh and have a family holiday too, whilst feeling a little like something from an Enid Blyton novel.

We hurriedly prepared Jonny, in the normal rushed pace of life we are used to and loaded with bikes, walking gear and an inflatable Kayak we headed over the Severn bridge and into Wales, excited and filled with anticipation as the sun set whilst we crossed our first UK border.

As usual my optimism with time meant that we were running late and a phone call was made to plead and agree a late arrival with a campsite manager who clearly would have

preferred to have been in the pub on a Friday evening! I had not yet relaxed into the Moto-rhome way of life where a lay-by or service station are possible overnights and was keen to start the holiday as planned... I put my foot down and with inexperience descended quickly over Epynt mountain. This resulted in a huge amount of smoke on arrival and the acrid smell of hot brakes. This was later followed with an anxious internet search in bed around midnight, reading about terminal braking failure and a lesson on how to descend with a 3.5 tonne vehicle. I went to sleep thinking the brakes will either work tomorrow or not and there was nothing I could do to change that fact!

We awoke to warm sun breaking through the mist and thankfully brakes that seemed to work ok now they had cooled. We had a quick first breakfast and Wendy and myself set off on the tandem to buy bread and orange juice around 9am (for second breakfast!) whilst the rest relaxed around the van. The tandem always creates interest, comment, and conversation, and often the same joke of "she's not pedalling on the back you know?!" So, we were not surprised when a lovely chat of over 20 minutes ensued outside the local shop with a retired cyclist and lifelong bicycle enthusiast. Allan (Welsh word for exit he told us) was keen to share one of his favourite local routes which he suggested would take about an hour to return to the campsite avoiding main roads and taking in the beautiful Irfon Valley. Allan's optimism seemed more developed than my own as we returned back to camp way past any chance of second breakfast in mid-afternoon after a thorough exploration, including Welsh cakes and a paddle at a waterfall and a cracking lunch at a café in Llanwyrtrd Wells. We had slipped into holiday mode with a vengeance and there was no exit from this adventure!

The next day saw our first peak, Pen Y Fan. At 2,907ft it is the highest peak in Brecon, South Wales and the UK, south of Snowdonia. It was a good one to warm up our legs with and



**Tel: 01985 845304**

59 The Rank  
Maiden Bradley  
Wiltshire  
BA12 7JF

E: [info@greenlifeplumbing.co.uk](mailto:info@greenlifeplumbing.co.uk)  
[www.greenlifeplumbing.co.uk](http://www.greenlifeplumbing.co.uk)

- *Oil and Gas Boiler Installs – Boiler Finance Available*
- *General Plumbing Works*
- *Full Central Heating Systems*
- *Underfloor Heating*
- *Renewable Installs – Air Source Heat Pumps, Biomass*
- *1<sup>st</sup> and 2<sup>nd</sup> Fix Plumbing Works – New Build, Extensions*
- *Bathroom Refurbishment, New Bathroom Projects*



508089



is generally a stunning view, weather permitting. We however had fog and mist forecast in the humid summer air, so with a quick prayer to our van homage to the 'God' Tom Jones for a sunny summit (we were gifted a feather framed picture of Tom in Gold sparkly speedo's which resides on our Motorhome bathroom door) we set off on our first climb. On route we stopped to help a young girl who had become separated from her family and was quite anxious and lent her our mobile and then a young couple carrying a rather heavy looking Bulldog puppy down who had overheated, giving them a full bottle of water for the dog. Either the prayer payed off or karma shone upon us as we walked through the cloud and onto Corn Du into hot blue skies and layers were duly removed. From here the saddleback to Pen Y Fan was magically covered in a blanket of cloud that moved constantly and was contrastingly very cool. In no time we were on the very flat summit of Pen Y Fan which appeared to be sat at the very lip of the cloud base, with blue skies above and dense cloud just inches below the earth we were stood on, it felt like we were on top of the world, or a tiny piece of Welsh heaven on earth. A very fitting start to our adventures and peak number 1 bagged, with a very happy & proud Poppy, who after whooping cough and resultant lung scarring at a young age had always felt a little anxious about going up, steeply! We celebrated with more Welsh cakes and fizzy drinks in the lay-by at the bottom.



3 days in Powys and we had fallen in love with the area, and with Wales, and agreed this was a destination to adventure a lot more, but now we were on the road to Snowdonia and with my new braking skills we soon arrived at Harlech on the West coast. Here I faced 3 tests, local drivers, very narrow rock edged roads and the challenge of not looking at breath-taking views whilst driving said narrow roads! Thankfully with Wendy's encouragement, the odd shout of

'car' and maybe a bit of luck we arrived safely at campsite number 2 at Merthyr Farm, Llanfair, and with dewy eyes from the view ahead of us we met Bryn. I think I was slightly high from the adrenaline of the drive and the amazing views but I will always remember the twinkle in Bryn's eye when I complimented him on the location of his farm, and in answer to my question he explained had lived on the farm for 50 years, his whole life, and had never really been anywhere else. Why would you I answered, this surely was perfection, high above the estuary in Harlech with sea views and the Snowdonia mountain range surrounding our vision I felt like we had landed in a celestial and earthy paradise, and hoped we may never leave, just like Bryn! This was a magical place that was either above the clouds or in them and we loved it. We chose a place to park the van next to a dry stone wall at the back of the field, overlooking the panoramic view of Harlech Bay, we climbed out of the van and all of us stood and took in the view in silence for some time before even starting to set up camp. Camp making in a motorhome is quite straight forward but involves quite a bit of teamwork, level the van, hook up the electric, switch on the gas, the water heater, switch the fridge from 12v to 230, wind the awning out, chairs and table then kettle on, or cold beer from the fridge! We had developed a method and were becoming slick and experienced, a must on sites where other experienced travellers seem to make a sport of watching the uninitiated struggle! This camp location seemed the most perfect spot to date.



That evening we had the first of many crazy thunderstorms that rumbled and flashed all around us but never over us and we spent the next 3 nights watching the lightening with awe. This became our evening entertainment and more than once I fell asleep whilst watching the storms from our bedroom window. The mornings we watched Meadow Pipets flying on and off the drystone wall and a rabbit who seemed to have his warren inside the wall would look at Archie in the window with a twitching nose. It felt wonderful to be so close to nature, the van becoming our own private hide & enabled us to come closer to our feathered and fluffy neighbours than normal.

**To be continued.....**

# Spring bulb project

In November, a team of volunteers are planting a variety of naturalising spring bulbs in the centre of Maiden Bradley: daffodils, snowdrops, crocuses and bluebells. The goal is to brighten up our village during the spring, as well as to signal to motorists that they are entering a village and thereby, we hope, to calm traffic speeds.

We are planting a variety of bulbs in natural swathes and clumps in various agreed spots around the 'village loop', all of which are identified on the map. If you want to help, please watch the village Facebook group for an announcement.

We are grateful to the Parish Council for funding this investment in the village and to the Estate for making it possible. We are also grateful to parishioners who donated bulbs for this project.

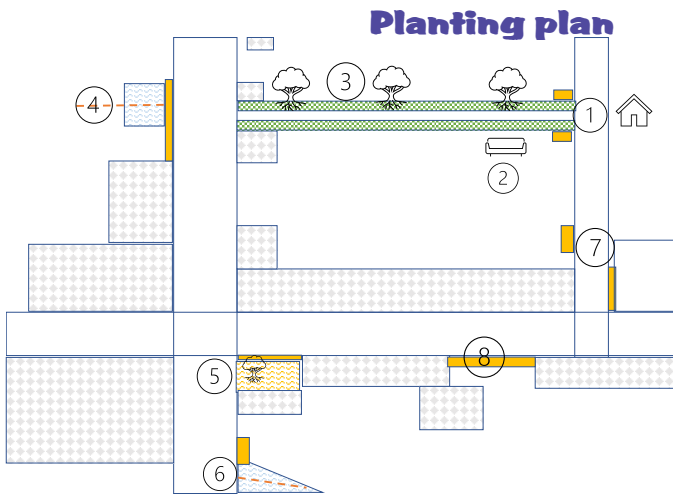

- 1 Plant swathe mixed daffodils around trees and wooden fence opposite entrance of Bradley House (500 daffodils and 400 crocus)
- 2 Plant swathe 'early spring mix' bulbs and some scented red devon daffodils around bench and tree opposite (1,250 mixed spring bulbs and 100 daff mix)
- 3 Plant 2 x swathe snowdrops on the banks on the curve of Back Lane, near the field gate. This is visible point from entrance to Back Lane. (600 snowdrops)  
Plant crocus/snowdrops around various trees etc. (400 snowdrops / 400 crocus)
- 4 Plant swathe mixed daffodils either side of entrance to footpath, opposite Back Lane, and if area inside just before swing gate is cleared, plant bluebells in wooded area (400 mixed daff and 200 bluebell)
- 5 Plant mixed daffodils along edge of the verge (nearest hedge) on Church Street, by the Knapp, leaving some space to mow and some crocus etc around trees (200 daff, 100 crocus)
- 6 Plant mixed daffodils along grassed area near entrance to footpath by recreation ground, and if area cleared, bluebells inside wooded area (200 daff and 200 bluebell)
- 7 Plant swathe mixed daffodils at the end of the bank, near turning behind the chapel, and along the wall of Community Garden (600 daff)
- 8 Plant mixed daffodils along edge of grass meadow on Church street (500 daff)



# SHARE YOUR FAVOURITE WALKS, BIKE RIDES AND RUNS AROUND MAIDEN BRADLEY

This spring and summer, many of us have enjoyed exploring our local footpaths, and we wondered if you would share your favourite walks, bike rides or runs with others.

We will publish your routes in the monthly Parish Newsletter. Next year, our plan is to publish a selection of routes in a booklet as this was something many villagers suggested in the parish consultation.

**We'd like a variety of walks, bike rides or runs by length, difficulty and landscape, with one condition:**

**They must all start and end at the Village Hall.**

When you describe the walk, please imagine you are walking it for the first time – explain each stage, including where you change direction. You can add notes of interest if you wish. What information do we need?

ROUTE TITLE: e.g. Maiden Bradley village hall via Bradley Woods returning to Maiden Bradley Church

TYPE: Is it a walk, run or bike ride?

STARTING POINT: Always start with this instruction: Standing with your back to the Village Hall, turn left / turn right up High Street ....

STEP 1: Give a step by step description of the walk e.g. Walk up High Street until you reach the footpath sign opposite Back Lane, and turn left toward the swing gate

NOTES: Any notes you want to highlight about the route

MAP: A rough map would be helpful (you can create your own map by signing into My Maps on Google Maps)

Please send your route and map to: [adrchanner@gmail.com](mailto:adrchanner@gmail.com)

# SEASONED FIREWOOD

## FOR SALE

### D R M FORESTRY

Drmforestry@hotmail.co.uk



07875 350226

01985 844878

**Hard wood logs sold loose**

Price includes local delivery around Maiden Bradley and  
the local area

Various sizes available From 8 inch



## Podiatry Care



*Professional, affordable foot care*

Registered Podiatrist with extensive NHS experience

Services include: -

Toenail cutting. Corn & hard skin removal. Diabetic foot care & so much more!  
Appointments available at your own home or at Maiden Bradley coffee mornings

For more information or to make an appointment, contact Kate on 07814 616404



The COLLEGE  
of PODIATRY



## Parish Council 13<sup>th</sup> October 2020

The Parish Council is starting to look at the Budget for next year and so would like to invite groups and clubs to apply through its Grant Application Process. See below policy process.

1.The Clerk to the council will receive all applications in the first instance. A designated Councillor, Councillor Ian Ferguson will then collate all the necessary information from the applicant ready for presentation and discussion at the appropriate Council meeting.

2.Applicants will be required to complete an application form which can be obtained from the Clerk or printed off the website, [www.maidenbradley.org.uk](http://www.maidenbradley.org.uk). All questions on the application form should be fully answered and additional appropriate information, which supports an application, should be provided.

3. In addition to the application form organisations will be required to provide the following supporting information:

A copy of their written constitution or details of their aims and purpose, full details of the project or activity, demonstration that the grant will be of benefit to the local community within the Parish, the proportion or number of beneficiaries living in the electoral area, demonstration of a clear need for the funding, a copy of the previous year's accounts or, for new initiatives, a detailed budget and business plan.

4.The Council will expect to receive in writing to the Clerk any expression of interest for a possible grant application exceeding £100 by 31st November of the financial year prior to the funds being required in order that budget provision can be considered.

5.The Council will make the decision on which grants to award. All applicants will be contacted following the Council's decision.

6.The Council has a limited budget each year and guidance can be given to applicants as to how much money is likely to be available in a specific financial year.

### Conditions of Funding

1.The organisation must be either non-profit or charitable. Applications will not be considered from private organisations operated as a business to make a profit or surplus.

2.Grants will not be made to individuals.

3.Grants will not be made retrospectively.

4.Applications will not normally be considered from national organisations or local groups with access to funds from national 'umbrella' or 'parent' organisations, unless funds are not available from their national bodies, or the funds available are inadequate for a specified project.

5.An organisation should have a bank account in its own name with two authorised representatives required to sign each cheque.

6.The administration of and accounting for any grant shall be the responsibility of the recipient. All awards must be properly accounted for and evidence of expenditure should be supplied to the Council as requested.

7.Only one application for a grant will be considered from each organisation in any one financial year.



8.Ongoing commitments to award grants or subsidies in future years will not be made. A fresh application will be required each year.

9.Each application will be assessed on its own merits.

10.The Council may make the award of any grant or subsidy subject to such additional conditions and requirements as it consider appropriate. The Council reserves the right to refuse any grant application which it considers to be inappropriate or against the objectives of the Council.

11.Any grant must only be used for the purpose for which it was awarded unless the written approval of the Council has been obtained for a change in use of the grant monies, and that any unspent portion of the grant must be returned to the Council by the end of the financial year in which it was awarded.

12.The Council may make the award of any grant or subsidy as it considers appropriate in the event of any unforeseen urgent event.

13.Nothing contained herein shall prevent the Council from exercising, at any time, its existing duty or power in respect of providing financial assistance or grants to local or national organisations under the provisions of the Local Government Act 1972, Section 137

**Items for the next Agenda:** Reserves and Contingency, General Reserves, Budget/Precept Preparations and Grants.

**Date of the next meeting.** The Council agreed that the 10<sup>th</sup> November 2020 would be the date of the next Parish Council meeting. As always, the Parish Council meeting will be open at the start with an opportunity for members of the public to ask questions or make comments on any matter. The website Southwilts.com (Maiden Bradley) can be accessed to read a copy of the Agenda and Minutes electronically or copies are displayed at the bus stop notice board.

Mrs Sarah Jeffries can be contacted by email on maidenbradley@virginmedia.com, by phone on 01985 213436, or post to Parish Clerk, 9 Beech Grove, Warminster, BA12 0AB



**Community litter pick**  
**Saturday 7th November**  
**10.00-12.00**

**Meet at the community garden on**  
**Kingston Lane**

Equipment provided – gloves, litter pickers, bags

Hand sanitizer available

Please follow social distance guidelines

# INSURANCE THAT'S ON YOUR DOORSTEP

Having a local office means we're accessible, whether you need to make changes to your policy or make a claim.

We can help you with a range of insurances, including:

- Home
- Car
- Business
- Farm
- Equine
- Travel

For a real conversation about your insurance call us or pop in

NFU Mutual Warminster, Perry Farm, Maiden Bradley, Warminster, Wiltshire BA12 7JD

Tel: 01985 845116

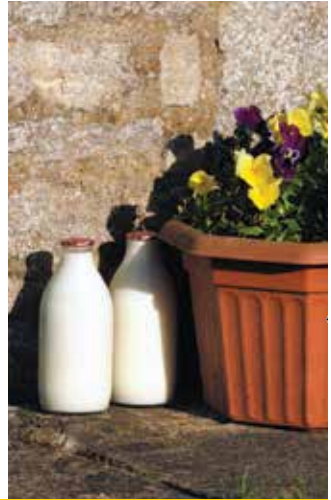

**NFU Mutual**  
INSURANCE | PENSIONS | INVESTMENTS

Our Agents are appointed representatives of The National Farmers Union Mutual Insurance Society Limited (No. 11982). Registered in England. Registered Office: Tiddington Road, Stratford upon Avon, Warwickshire, CV37 7BJ. Authorised by the Prudential Regulation Authority and regulated by the Financial Conduct Authority and the Prudential Regulation Authority. A member of the Association of British Insurers.

D:0F78B40

## E G MARTIN LTD



for all your  
**Central Heating Oil**

**01373 822784**  
**enquiries@egmartin.co.uk**

***your local central heating  
fuel distributor***

**JERRY RAYNER** ●  
boiler maintenance ●

**Call 01985 841461**  
**or 07775 755981**

For servicing and  
breakdown of oil boilers

- Competitive rates
- Friendly, helpful & efficient
- Call now for a quote

**COMMUNITY SPEED WATCH NEWS**  
**Police Community Volunteers working on behalf of**  
**the Wiltshire Police and Maiden Bradley**



Welcome to Community Speed Watch News, compiled and produced by the Maiden Bradley Community Speed Watch Volunteers to keep the village aware of our activities.

There has been a lot of CSW activity this month despite the weather on occasions.

7th October 2020 Church Street 199 vehicles No excessive speeds recorded

9th October 2020 Church Street 168 vehicles No excessive speeds recorded

9th October 2020 High Street 40 vehicles No excessive speeds recorded

9th October 2020 Frome road 146 vehicles recorded 25 excessive speeds recorded One recorded at 43 mph A lot of aggression show to CSW team

14th October 2020 Church Street 192 vehicles recorded 1 excessive speed recorded

16th October 2020 Frome Road. 166 vehicles recorded 4 excessive speeds recorded. One at 44mph A lot of aggression was shown to the CSW team.

16th October 2020 High Street 53 vehicles recorded 9 excessive speeds recorded. Two police officers attended this session to give support.

**CSW is not all aggression and aggravation.**

While waiting for the two other members of our CSW to arrive at the spot we were going to operate. A car pulled up alongside me. I thought ho ho here we go, abuse before we even start. So I reached for me handbag (*Well it worked for Thatcher*)

I could not have been more wrong! The driver said. Excuse me are you running the community speed watch this morning. Yes I said a bit puzzled. Good he said as I just wanted to compliment you on the work you are doing in the village with your speed watch activities. Since you have been active again the speed through the village has slowed down a lot and made it easier and safer through the village. I pass through the village every day. I thanked him for his compliment and he went on his way having declined to give his name.

That compliment has made it all worthwhile for all the CSW teams in Maiden Bradley.

Thank you for all your support in the CSW activities and for your support in the future.

*Simon Wager*

Simon Wager. Community Speed Watch Co-ordinator.  
Vice Chairman Maiden Bradley Parish Council

# REMEMBRANCE SUNDAY NOVEMBER 8TH 10.45 am

TO ENABLE SOCIAL DISTANCING PLEASE  
EMAIL OR PHONE SARAH NEISH  
TO BOOK A PLACE AT THE SERVICE  
[sarah.neish@hotmail.co.uk](mailto:sarah.neish@hotmail.co.uk) 01985-844689  
DUE TO COVID-19 MASKS MUST BE WORN



WE WILL  
REMEMBER

