

# Maiden Bradley Parish News

372 June 2020



Hare by Steve Gunter

# June Diary

1	Mon	Green bin collection
3	Wed	Recycling collection
8	Mon	Household waste collection
15	Mon	Green bin collection
17	Wed	Recycling collection
22	Mon	Household waste collection
29	Mon	Green bin collection



## Useful Telephone Numbers

Speed Watch Co-ordinator	Simon Wager	simon.m.wager@gmail.com
Community Garden		01985 844917
Book Club	Jessica Johnson	01985 844174
Pilates		01985 511693
Cookery Demonstrations	Rosie Brown	01985 844236
Luncheon Club		01985 844779
Welcome Club Outings		01985 844779
Scrabble Club		01985 844919
Memorial Hall bookings		01985 845303
Dr Andrew Murrison MP		01225 358584
	murrisona@parliament.uk	
Mere Link Scheme		01747 860096
Rev. Carol Wilson-Barker		01747 861859



The shop is open in the Village Hall on Mon, Wed and Fridays 9-11.30am

The post office is open in the Village Hall on Tuesdays 1-3pm

Bell Ringing Tuesday 7 pm in the Bell Tower at the Church, beginners welcome 844475 -

Coffee Mornings every Friday in the Hall 10 am till 12 noon

Maiden Bradley Parish News – contributions are preferred in editable text format.

Email [pat@visa-office.com](mailto:pat@visa-office.com)

**Magazine available online at [www.maidenbradleyvillage.org.uk](http://www.maidenbradleyvillage.org.uk)**

## Editorial

Welcome back to a printed Maiden Bradley Parish News. We have decided to start printing again mainly because there has been a slight lifting of Covid 19 restrictions, namely we are now allowed outside more than once a day and the committee feels sufficiently confident to deliver the News to the village with outlying recipients collecting from the shop.

We trust that everyone has avoided the virus which has killed now over 36.000 UK residents. Life is certainly not back to normal and we still need to socially distance. At present, junior schools may reopen on 1st June with the hospitality industry making a re-appearance at the beginning of July. How social distancing will work in these areas, produces significant problems and I envisage a slow return to a different way of life until there is a vaccine.

The Diary is of course, quite empty for now and probably like most of you, I look forward to the time when it will flourish with the village activities but if you need something to do now, read Rosie Brown's article.

Pat Kennedy 845397 pat@visa-office.com

## WELCOME TO MAIDEN BRADLEY

Welcome to Mags & AJ & Becky, Dave and their children Chloe and Jack to High Street and also to Jannine & Tom from Australia to Church Street. Looking forward to meeting you all at our coffee mornings or film nights in the Memorial Hall.



Tel: 01985 845304

59 The Rank  
Maiden Bradley  
Wiltshire  
BA12 7JF  
E: [info@greenlifeplumbing.co.uk](mailto:info@greenlifeplumbing.co.uk)  
[www.greenlifeplumbing.co.uk](http://www.greenlifeplumbing.co.uk)

- *Oil and Gas Boiler Installs – Boiler Finance Available*
- *General Plumbing Works*
- *Full Central Heating Systems*
- *Underfloor Heating*
- *Renewable Installs – Air Source Heat Pumps, Biomass*
- *1<sup>st</sup> and 2<sup>nd</sup> Fix Plumbing Works – New Build, Extensions*
- *Bathroom Refurbishment, New Bathroom Projects*



508089







Locking down has given us the chance to reflect on the way that we acquire stuff. Clearly the internet has been a great help in this regard (perhaps dangerously) offering us the chance to buy from an absurdly wide palette of shopping.

So how about the Buyerarchy of Needs as a way to help us make environmentally informed choices about our purchasing? It is from the excellent book 'The Sustainable(ish) Living Guide' by Jen Gale (who, coincidentally lives in Warminster).



The idea is adapted from Canadian designer/journalist Sarah Lazarovic. It sums up brilliantly the way that we need to think about consumption.

In the spirit of this I have just signed up for Streetbank which is an online Share Shop (like the one in Frome which gets a mention in the book). People post things you want to lend or give away and you can borrow or use things offered. I'll let you know how it goes, there are a few people signed up in our area already. With this kind of initiative there is a critical mass needed to make it work so if you are tempted to sign up then go for it!

Please send ideas, thoughts or photos to Kate Moore for next month's issue (especially now as we are so short of events to read about!)

[kate.moore@silkmillstudios.co.uk](mailto:kate.moore@silkmillstudios.co.uk) or 844305

# **NEWS FROM THE MEMORIAL HALL**

## **HOW WELL DO YOU KNOW YOUR VILLAGE?**

### **Maiden Bradley Memorial Hall Outdoor quiz.**

How about taking a quiz sheet with you when you are on your daily turn about the village getting your daily exercise? An opportunity to have a bit of fun and see how good your observational skills are either with your family or own your own if you prefer.

As you are probably aware, due to COVID 19 all planned activities and events in the Memorial Hall have been either postponed or cancelled. This has, of course, had an impact on our income and bills still have to be paid. We would therefore ask for a contribution of £2.00 per quiz sheet (additional donations always welcome).

There will be a first and second prize for the overall winners (in the event of a tie an additional question will be asked).

All completed quiz sheets should be returned to the Hall (in an envelope please) by noon Friday 26th June. Winners will be notified during the first week of July

**Quiz sheets are available from the shop situated in the Memorial Hall  
(open Mon, Weds & Fridays 9am – 11.30am)  
by phoning Sheila Foley on 01985 844218  
or from any Management Committee member**

*When you come into the Hall raise your eyes  
and admire our lovely new ceiling.*

*Re-plastering work has taken place during the  
month of May and is looking good!*

*Following completion of the ceiling members of the  
committee are working hard giving the hall  
a deep clean.*

*When you come into the Hall be sure to wear your  
sunglasses as everything will be gleaming!*

**Any fundraising ideas during this time of  
social distancing will be greatly received –  
come on get your thinking caps on  
and get in touch.**

**- REMEMBER -  
HAVE FUN  
STAY ALERT  
KEEP SAFE**

## **M H Plastering & Building Services**

For a no obligation quote  
please call 01373 301009  
or 07785 226262 or email

[info@mhplasteringandbuilding.co.uk](mailto:info@mhplasteringandbuilding.co.uk)

### **SERVICES WE OFFER:**

Rendering ~ Plastering  
Floor Screeding ~ Dry Lining  
Stud Walls ~ Floor Tiling  
Wall Tiling ~ Pointing  
Brick & Block Work  
Lime Work for Restoration



# **M B Life in Lockdown**

**Please write a short piece about how Coronavirus , Covid 19 and the Lockdown has affected your life in Maiden Bradley.**

I have been asked by the village hall management committee to ask all villagers to write about how you have adapted or changed your life during and after lockdown. Have you learnt a new skill or activity, or made a new friend or discovered something new in the village? Or have you finished off a craft or piece of art or restored a pond or a piece of furniture during lockdown?

**We would love to hear from you and put all your contributions into a booklet to keep as part of the history of the village.**

**The sale of the booklets will go towards the village hall funds.**

Please write up to 200 words either by hand or typed up.

Please include a photograph if you wish,  
your name and a contact number and send to

**[rslbrown@hotmail.com](mailto:rslbrown@hotmail.com)**

or send it to me at 56-57, The Rank, Maiden Bradley.

Closing date for the written contributions is: Tuesday 30th June 2020.

If anyone is interested in helping me to collate and create the booklet, please let me know on 01985 844236.

**Rosie Brown**



## Don't delay seeking medical help because of coronavirus

People living in Wiltshire are being advised not to let worries about coronavirus stop them asking for medical help for themselves or their children if they become ill, have a serious accident or have a concern about their health.

They are also being warned that not seeking medical help for symptoms that could be the early warning signs of serious conditions such as cancer could be putting lives at risk.

The warning comes as new data shows a considerable drop in the number of people coming forward to ask their GP for help and advice during the coronavirus outbreak.

Recent statistics show that, in Bath alone, the total number of weekly referrals from GPs to the Royal United Hospital have fallen from around 2,000 at the beginning of March to 300 at the end of April.

In Swindon, the average number of patients being sent by their GP to the Great Western Hospital for further investigations into symptoms that suggest cancer each week has dropped by more than 200 to 80.

Dr Ruth Grabham, Medical Director at BaNES, Swindon and Wiltshire CCG, said the statistics made for worrying reading because the drop in numbers "is not because people are not experiencing symptoms."

"While it may seem that coronavirus has put a stop to most aspects of everyday life, the one thing it hasn't stopped is what's going on inside our bodies," she says. "Now more than ever, we need to pay attention to anything that isn't normal and seek help early on.

"For example, if you notice blood when going to the toilet, or if you've found a lump that wasn't there previously, or if you've just noticed something odd that is causing you to worry, you need to speak to your GP.

"Should the symptom be the early warning sign of something serious like cancer, that delay in seeking help could have serious implications for how successful possible treatments may be."

Although GP practices across the region have adopted new ways of working, such as establishing isolated clinics for potential coronavirus patients, the practices themselves are still open to offer care, treatment, advice and peace-of-mind.

The same also goes for emergency departments at the three hospitals in Bath, Swindon and Salisbury, all of which continue to be open 24 hours a day for people with a genuine and life-threatening health concern.

Additionally, all healthcare facilities in the region, as well as those elsewhere in the country, have put in place stringent infection control measures to ensure that the risk of contracting coronavirus while visiting a hospital or GP surgery remains low.

- Details of which services continue to open, as well as how to get in contact, can be found online by visiting [www.bswccg.nhs.uk](http://www.bswccg.nhs.uk)
- For information about local hospital services visit <https://www.ruh.nhs.uk/>, [www.gwh.nhs.uk](http://www.gwh.nhs.uk) or [www.salisbury.nhs.uk](http://www.salisbury.nhs.uk)
- Further information on how to stay well throughout the coronavirus outbreak can be found at [www.nhs.uk/conditions/coronavirus-covid-19](http://www.nhs.uk/conditions/coronavirus-covid-19).

# COMMUNITY SPEED WATCH NEWS

**Police Community Volunteers working on behalf of  
the Wiltshire Police and Maiden Bradley**



Welcome to Community Speed Watch News, compiled and produced by the Maiden Bradley Community Speed Watch Volunteers to keep the village aware of our activities.

With the drop in vehicular movements through the village on the B3092 created by the current Lock Down caused by Covid19. There is a significant increase in the speed of traffic through the village right across the vehicle range. This of course is causing a lot of concern with the increase in the number of parishioners young and elderly who walk to take exercise. I have no doubt we are not the only parish to notice this.

Our PCSO Candida Jackson has passed this information to CPTN Sergeant Harmsworth who is on the neighbourhood team so he will forward this to the 5 Response teams that are on duty around the clock in Warminster and to their sergeants. There should be some checks in the pipeline.

The speeding increase does show the effectiveness of the activities of our Community Speed Watch teams who at present are prohibited from any Speed Watch Activity because of the current C19 restrictions. Rest assured the moment the restrictions are lifted we will hit the street. As always we still need more volunteers to help with this important duty, so if you would like to join the team just call me on 01985 844848 and start the process of being a Community Speed Watch Volunteer.

Keep Well Keep Safe

*Simon Wager*

Simon Wager. Community Speed Watch Co-ordinator.

Vice Chairman Maiden Bradley Parish Council

**SEASONED FIREWOOD**

**FOR SALE**

**D R M FORESTRY**

**Drmforestry@hotmail.co.uk**



**07875 350226**

**01985 844878**

**Hard wood logs sold loose**

Price includes local delivery around Maiden Bradley and  
the local area

Various sizes available From 8 inch



# THE HISTORY OF MAIDEN BRADLEY - THE 19TH AND 20TH CENTURIES

By Mr Hugh D. Kitching

At the beginning of the 1800's very little was happening except for one rather interesting thing. A man called Doctor Lankester got the idea that universal education was desirable. He managed to persuade the 11th Duke, Edward Adolphus, who had built two semi-detached houses (numbers 25 and 26 Church Street) to participate. On the ground floor were classrooms and the upper floor provided accommodation for the teachers. Doctor Lankester had a school of his own in which he taught young men



of ages eighteen to twenty how to teach and pass on their knowledge. When they passed the course they became known as monitors. How many village children passed through this educational system is not known, neither is the reason it ended after running for ten years, but this was a noble attempt to give ordinary people an education.

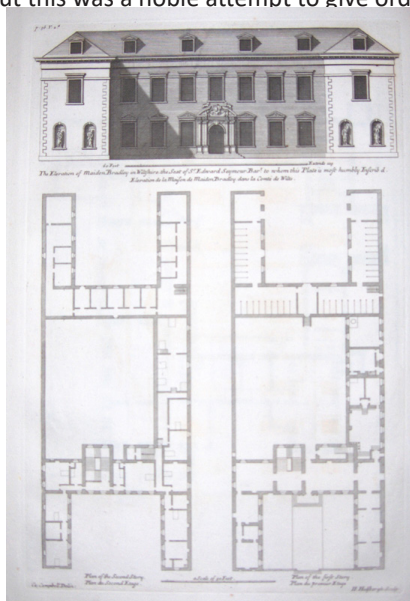

The next thing that happened was that the same Duke, the Eleventh, decided that he had too many mansions and did not want to keep them all. He had a large house in Leicestershire, another equally large one in Buckinghamshire, property in Devonshire and Bradley House which in those days was much larger than it is at present. He decided to demolish most of Bradley House, which was a pity because about seven-eighths of it was pulled down in the 1820s. The only benefit to the Village was that the Chapel was built from recycled material in 1822 and some of it was used to build additions to the other houses. By 1825 the demolition was completed leaving the present Bradley House, then known as the Hunting Lodge, one-eighth the size of the original.

Bradley House was not the only one of the Duke's houses to be pulled down. His big house in Buckinghamshire, Bulstrode, must have been almost completely demolished as in its chapel was a Flemish stained glass window showing the conversation of Saint Paul which was brought to Maiden Bradley and installed in the Parish Church of All Saints. The window remained in the Church until the 1960s when the lead got so fragile that the glass was removed, it being too expensive to restore. It was given to a City of London church, Saint Andrew's by the Wardrobe, where it was re-assembled and can be seen to this day. So some good came from it after all.



One of our villagers who had served in the Battle of Waterloo set up in 1817 a little shop at numbers 11 and 12 Church Street where Jean and Douglas Ball and Marilyn Doel now live. It was called a Tom and Jerry, why I do not know, but it must have had a liquor licence for the bellringers from the church would assemble there after practice for a drink or so.

During this time the Eleventh Duke had two boys. The elder, Edward Adolphus Ferdinand St. Maur, who was always known as Ferdie, must have been adventurous, to put it mildly. When the Indian mutiny broke out he paid his own passage to India, joined the army and saw action at the relief of Lucknow. No sooner had he returned to England than Garibaldi, the Italian Patriot, and started trouble in Italy so he joined Garibaldi's forces. Also he was a bit unusual in that he met a girl called Rosie, the daughter of a local blacksmith, with whom he lived and had two children.

At first Ferdinand and Rosie lived, not locally, but possibly at Brighton on the South Coast. Eventually, the Eleventh Duke provided them with a home in Maiden Bradley - what is now the Old Dower House. It was converted from a cottage to a large house with twenty or so rooms. Ferdinand died of tuberculosis in 1869 at about the time the house was completed. Rosie was pensioned off and the children, a boy and a girl, were adopted by the Duke who brought them up. He did everything he could to make their lot easier including educating them. The children lived at Stover, the Duke's estate in Devonshire, and did not come to Maiden Bradley. The author met the children's grandparents in 1950 at Bradley House. The girl married the Duke of Portland.



The Duke's younger son, unmarried, was killed by a bear, on a shooting trip while on a visit to India.

Until the middle of the 19th century villages such as Maiden Bradley were virtually self-governing. This was achieved by the Manor Court appointing, for a yearly term various villagers to carry out (part time) the necessary duties. Some of these were so unpopular that exemption could only be gained by being a witness in a successful prosecution for a felony. The appointments made included 1) The Constables 2) The Hayward, 3) The Well Watchers, 4) The Ale Tasters, 5) The Chimney Peepers and 6) The Bread Weighers.

# INSURANCE THAT'S ON YOUR DOORSTEP

Having a local office means we're accessible, whether you need to make changes to your policy or make a claim.

We can help you with a range of insurances, including:

- Home
- Car
- Business
- Farm
- Equine
- Travel

For a real conversation about your insurance call us or pop in

NFU Mutual Warminster, Perry Farm, Maiden Bradley, Warminster, Wiltshire  
BA12 7JD

Tel: 01985 845116



**NFU Mutual**  
INSURANCE | PENSIONS | INVESTMENTS

Our Agents are appointed representatives of The National Farmers Union Mutual Insurance Society Limited (No. 11982). Registered in England. Registered Office: Tiddington Road, Stratford upon Avon, Warwickshire, CV37 7BJ. Authorised by the Prudential Regulation Authority and regulated by the Financial Conduct Authority and the Prudential Regulation Authority. A member of the Association of British Insurers.

D-0F78B540

## E G MARTIN LTD



**for all your  
Central Heating Oil**

**01373 822784**  
**enquiries@egmartin.co.uk**

***your local central heating  
fuel distributor***

**JERRY RAYNER** ●  
boiler maintenance ●

**Call 01985 841461**  
**or 07775 755981**

**For servicing and  
breakdown of oil boilers**

- Competitive rates
- Friendly, helpful & efficient
- Call now for a quote

The Constable was responsible for the law and order. The immediate mans of enforcement were the lock-up, stocks and pillory. The lock-up still remains, part of a private residence. The stocks and pillory were between the lock-up and the present bus shelter. Serious offences were the concern of the Sheriff of the hundred at Mere.



The Hayward in the days of strip cultivation of communal fields, had to see that horses, cattle, oxen, sheep and pigs did not trespass on to the hay fields. Any offending animal was impounded and only released on payment of a fine.

The Well Watchers were responsible for the good condition of well caps and surrounds. There were over a dozen very deep wells and it was essential that, when not in use, children and animal could not fall in.

The Ale tasters, one imagines, held one of the more pleasant jobs involving the passing, for human consumption, of the home made brews made by local inns and ale houses.

The Chimney Peepers must have had an invidious job entering homes and inspecting chimneys. As thatch was the usual roofing material and most houses were terraced, a fire could put the whole village at risk. This happened about 1820 when most of the village was destroyed by fire.

The Bread Weighers had to ensure that loaves from local bakeries were not short weight. Bread was the stable village diet and checking by the Bread Weighers would certainly deter any would be dishonest baker.

In 1865 Church Farm, which originally was close to the Church, was rebuilt at its present location and in the same year the Somerset Arms was built. During the coaching era, forty or fifty years previously, the Village had three coaching inns and two other inns which catered for those travelling on the intersecting Bath-Poole and London-Barnstable coach routes. There must have been a great deal of unemployment in Maiden Bradley when the last coaches went.

In the 1890s, Algernon, the 15th Duke of Somerset, decided that he would like running water in Bradley House. On Mapperton Hill a reservoir was dug to which was water was pumped from a pond on Priory Farm which received about eight million gallons a day from a spring on the adjacent hillside. The old pump is still in existence having been presented to the Steam Museum, Kew Bridge, London by John the 19th Duke of Somerset.





When the reservoir was finished Bradley House had running water and the Duke very generously supplied water to the villagers via standpipes, one of which catered for every five or so houses. This innovation meant that the inhabitants no longer had to draw water from the wells. The deepest well at 55 The Rank, was one hundred and twenty feet deep and it would have been quite an effort to raise a bucket of water. The site of one of the standpipes i.e. upright pipes from which water could be tapped, can be seen at my

former house, 4 Kingston Lane. Most cottages had a water butt in which rainwater from the roof collected, thus eking out the supply carried from a standpipe.

In about 1869 the Church built a school for the children of the Village which was very popular. In 1900 there were over a hundred children attending the school but with the dwindling population and economy measures the school was forced to close and the children now go to Kilmington School.



In 1885 legislation was passed which changed several local boundaries. When the manor was first granted in 1066 it included an area called Little Horningsham. To find it you go along the Warminster road, turn left on to the Horningsham road and go as far as Round Hill Farm. Here you leave the metaled road and go down a lane as far as Pottle Street. Turning right you continue along Pottle Street to the end of the metaled section which leads you to another green lane meeting, once again, the Warminster Road near Baycliffe Farm. All the land to the right on this walk constituted Little Horningsham.

Late in the 1800's two Friendly Societies, which subsequently merged, were created in the Village. Throughout the late 1800's and early 1900's they provided benefits to needy subscribers well before the advent of government run social services. The author couldn't help smiling at the fact that they had a money chest into which the subscriptions were put and to make quite sure that there was no embezzlement, there were two separate locks on the chest. The two treasurers each had a key to unlock one of the locks. They made quite substantial payments for such necessities as coal, winter blankets and money for the payments of medical expenses. The Friendly Society was finally wound up and handed over to one in Trowbridge in about 1922.



 Follow 'Fostering in Wiltshire'

*Could you offer a stable and supportive home?*

We need foster carers who can provide a loving, supportive home for children in care. We will provide you with suitable placements to match your circumstances. You will be part of a professional team and be provided with your own support worker, ongoing training and a 24 hour helpline. In addition, you will be paid a generous allowance.

**Interested?**

Call us today on 0800 169 6321, email [fostering@wiltshire.gov.uk](mailto:fostering@wiltshire.gov.uk) or go to [www.wiltshire.gov.uk/fostering](http://www.wiltshire.gov.uk/fostering)

*Be the difference – become a foster carer with Wiltshire Council*

**Fostering**  
be the difference

**Wiltshire Council**  
Where everybody matters

# GREEN MAN



**Professional,  
Eco-friendly  
Carpet, Hard Floor,  
Rug & Upholstery  
Cleaning**

**FROME: 01373 470416**

**NCCA**<sup>®</sup>  
NATIONAL CARPET CLEANERS ASSOCIATION  
CLEANING THE NATION'S CARPETS AND UPHOLSTERY

MEMBER 3007

**[www.greenmancleaning.co.uk](http://www.greenmancleaning.co.uk)**

With the closing of the coaching era and the introduction of mechanisation on the farms, there began a steady decline in the Village population, particularly in the number of farm labourers.

The author was lucky enough to come across a book which showed that, in 1911, the 15th Duke started a men's club and he was one of the hundred and five members. Most of the members must have been farm workers because, although the seed drill and multiple plough had been invented by Mr Jethrow, a barrister and resident of the village, there was no mechanisation at all. The club continued until 1913 when, subsequently, many ex-members served in the armed forces during the Great War of 1914-18.

As a sequel to the War a branch of the British Legion was formed and this survived until seventy years later when only four members remained.

I came across a note dating from after the 1914-18 War that showed that there was a rifle range somewhere in the Village. site uncertain, and some volunteers who may have been regular soldiers or possibly member of an original "home guard".

When Duke Algernon was in charge here he had several brothers, all of whom predeceased him, leaving no male heirs. So when he died in 1923 there were, therefore, several claimants to the Dukedom. They were the Marquess of Hertford whose claim came from the speaker Seymour of 1680, about 1650 or 1660, the present line of Dukes and lastly, the grandson of Ferdinand who came to the House of Lords in 1923 to assert his claim to the title.

The Marquess and Ferdinand's grandson admitted that a Lieutenant-Colonel Francis Seymour had married a girl called Leonora in about 1740 or 1750 and had children by whom the present Duke's line claimed descent. What was alleged was that Leonora had previously married a man called Smith, who was in the Marine section of the East India Company. It was claimed that Mr Smith was alive at the time of Leonora's marriage to Lieutenant-Colonel Seymour despite his wife having been informed of his death from cholera aboard ship in Calcutta, probably by a fellow passenger. When the House of Lord's heard all the evidence it was concluded that Mr Smith had died before she married Lieutenant-Colonel Seymour. Ferdinand's grandson could not produce any evidence that Ferdinand had married Rosie.

**ALLSOP CARPETS & FLOORING**

DOMESTIC ♦ COMMERCIAL ♦ INDUSTRIAL



Christchurch Street West, Frome. BA11 1EB

**TEL: 01373 463866**  
**MOBILE: 07887 953014**

[www.allsopcarpets.co.uk](http://www.allsopcarpets.co.uk)

Between the World Wars the local branch of the British Legion, now the Royal British Legion, at Christmas time helped out by giving "Christmas coal" to the less well-off members and the widows of the First World War dead.

When the 1939-45 War started there was a further 9 of men. a number of whom died for their country The men who gave their lives in two World Wars are commemorated in the Parish Church of All Saints and are as follows:

#### 1914-1919

Sergent Arthur Charles ADLAM MM, Scots Guards  
Pte Percy George ADLAM, 37th Training Reserve  
Pte Sidney ALDRIDGE, 1st Wiltshire Regiment  
Pte Walter ALDRIDGE, 8th Somerset Light Infantry  
2/Lt John Bartrup T HARWOOD BAKER, 8TH Royal Fusiliers  
Pte Charles CLARK, 2nd Royal Warwickshire Regiment  
Pte William John CLEAL, 2nd Wiltshire Regiment  
Pte Harold Uriah DOMAN, 5th Wiltshire Regiment  
L/Cpl James FORD, 7th Royal Dublin Fusiliers  
Sgt Arthur Charles FLOWER. 1/5th Somerset Light Infantry  
D N G Wilfred John GREENING, OS HMS Vivid  
Gnr Francis George HOWELL, Royal Field Artillery  
Gnr Frederick HULANCE, Royal Garrison Artillery  
Cpl Frederick Charles NEWBURY, 4/1st Herts Regiment  
Pte Russell PROWSE, Royal Army Medical Corps  
Pte Victor William WHITE, 5th Wiltshire Regiment

In all, 350 men from the Duke's estates served in the First World War.

#### 1939-1945

Sqd Ldr R EYTON-WILLIAMS, Royal Air Force  
Sgt H JEFFERYS, Royal Wiltshire Yeomanry  
Fit Lt R N P LUFF DFM, Royal Air Force  
Sgt M G Luff, Royal Wiltshire Yeomanry  
Pt D B McCLEOD, Royal Army Service Corps  
Cpl J W PEPPER, Coldstream Guards  
Smn W J R TOMBLIN, Royal Navy

During the 1960s there were several organisations in the Village including the Women's Institute, Mother's Union, Girl Guides, Brownies, Boy Scouts, cricket and football teams, and a brass band some of which have ceased to exist at the time of writing. However, in recent years a new spirit has appeared in the Village resulting in the inauguration of the Gardening and Social Club, the Owlets/Preschool group, the Youth Club, the Historical Association and the Bird Watchers' Club. About a year ago the Women's Institute was restarted.

Several of the former village surnames have disappeared but two, namely the Snooks and the Newburys, have survived.

The author is grateful to the Wiltshire Federation of Women's Institutes for allowing him to include the following extract from "Moonrakers - a little book of Wiltshire stories", which was first published in the early part of the 20th century and was printed by Coates and Parker of Warminster. In 1979 it was re-printed to celebrate the Diamond Jubilee of the Wiltshire Federation of Women's Institutes.

## **MAIDEN BRADLEY - OLD CUSTOMS AND GAMES**

The parish has few old customs and games, though thirty or forty years ago there appears to have been traces of Mummers Plays.

The custom of playing at ball on Palm Sunday along Long Knoll was once very prominent, but during the last quarter of a century it has declined considerably. Beating the bounds, or perambulating the parish, was up to within the last fifty years a somewhat coarse method of amusement that seems to have been greatly relished. A trap, laden with drink and eatables, was driven along the boundary line. If a stranger was seen coming along the road, a halt was made, a cross "hooked out" with a spud on the wayside waste and the stranger invited to have a drink and feed. If he innocently partook of the repast he had to face the penalty of being stood upon his head and well beaten with the shovel. Once silk-workers going from the Deverills to the silk works at Mere were molested in this manner. In such a rough and unbecoming way that trouble resulted, which terminated only by profuse apologies from the Estate agent.

Bumball Toohey, a very ancient game, was the favourite game of the drinking houses of the village. While enjoying this game, once a visitor to Bradley Fair stated that Archbishop Laud had been caught with a crucifix under his vest. This remark caused the unwary traveler subsequent trouble.

The game of Trap was freely played upon the village green, now enclosed and planted with trees. Boys used to vie with each other in trying to hit a ball from the village stocks over the houses forming the Rank and not infrequently this resulted in broken windows, and thereby became a nuisance to the place. The game, if it can be so-called, is perhaps the Village Dance which until quite recently was indulged in upon important occasions by everyone who cared to join.

The absence of remains of ancient games, etc., might be due to the fact that the village life during the 16th and much of the 17th century was dominated by such straight-laced Puritans as the Ludlows and Wanseys. Beck with buttons was a variety of pitch and toss which it is feared a former schoolmaster of the place did much to destroy.



Tailored Lettings &  
Property Management  
Residential Sales

**Mere - 01747 356176**

**Maiden Bradley - 01985 844972**

**Andrew & Anne Freeman**

Local, Reputable, Honest & Approachable

Free No Obligation Valuations

**amuletresidential@gmail.com**

**Find us on Facebook**

**www.onthemarket.com**

## **INTERIOR PAINTER & DECORATOR**

**20+ YEARS EXPERIENCE**

**Kaaren Arenka**

Mobile: 07707 156 498

Email: [kaaren.arenka@gmail.com](mailto:kaaren.arenka@gmail.com)



## OLD AND NEW VILLAGE STREETS AND NAMES



Starting at the cross roads (in ancient times known as "The Four Wents") and going west on what is the Bruton Road, the first part from the swimming pool for 200 Yards or so to Hollow Lane (the first turning on the right) was known as Horse Fair. On past Dangells Barn Farm, opposite to where Chip Cottage stood, the road forked, that on the left going to Yarnfield and Bruton, that on the right following the old Roman Road to Gare Hill through Penstones Wood, which was known as Bradley Lane. From Gare Hill going downhill to the County Bridge on the Frome Road was a bridle path known as Honeypot Lane. Going south from the County Bridge, the Frome Road ran as now, Mill Lane leading down to Priory Farm. The next diversion was the road leading down to Dunkerton and the former waterworks, known as Trowe Lane. From here the present section of Frome Road as far as the Cross Roads was built in 1730 for the convenience of coach traffic. Going east at the cross roads was East Street (now High Street) and where the Horningsham Road intersects the Warminster Road (formerly known as Dead Maids Corner) there was a path-way through the present Penneys Wood known as Forest Road. Finally, going south from the cross roads is, and was, Church Street; Kingston Lane coming into it between Bradley House and the Church, opposite the private road to Church Farm. It was not until about 1800 that Kingston Lane was diverted to its present course.

*Many thanks go to  
Victoria de Mare and Celia Blay  
for submitting this great article.*

### Elizabeth Gittoes

Registered  
Osteopath



Consultation by prior  
arrangement. Please  
call Elizabeth to make  
an appointment.

Email: [lizgittoes@yahoo.co.uk](mailto:lizgittoes@yahoo.co.uk)  
Telephone: 01747 840496

The Old Police House  
Stourton, BA12 6QG.





## MAIDEN BRADLEY BOOK CLUB

**Our friendly club meets at 8.pm, monthly, except in August. Each month, a different club member hosts the meeting in their home where we enjoy light refreshments, a good chat and a chance to air our thoughts about the book we read in the preceding month. It is fun, relaxed and welcoming to anyone who enjoys reading and would like to join us.**

**For more information and the year's list of meeting dates, please contact Jessica Johnson:**

**Phone: 07515 286429 or 01985 844 174**

**Email: [jessica07johnson@gmail.com](mailto:jessica07johnson@gmail.com)**



Rural Business Services was established in 1997 to provide professional book-keeping and administration services for small to medium sized rural based businesses. In addition we offer first class Project Management, sound sensible Business Administration & Financial Solutions together with Board Level Financial Management Experience. No matter how small or big your requirement is we can tailor support to suit your business needs either on or off site.

For more information or to discuss your requirements contact  
Lucinda Stokes on 01985 844017  
[www.ruralaffairs.co.uk](http://www.ruralaffairs.co.uk) • email: [lucinda@ruralaffairs.co.uk](mailto:lucinda@ruralaffairs.co.uk)



Garston  
Veterinary Group



### Laser therapy

Laser therapy is a non-invasive treatment using specific wavelengths of light (red and near-infrared) to create therapeutic effects which can improve wound healing time, pain reduction, increased circulation and decreased swelling.

We are offering **10% off** Laser Therapy treatments during March & April.

Laser Therapy Treatment sessions are held at our Warminster and Trowbridge surgeries.

Please contact your usual surgery to make arrangements.

Frome	Melksham	Trowbridge	Warminster	Westbury
01373 452225	01225 617779	01225 754021	01985 213350	01373 301448



[www.garstonvets.co.uk](http://www.garstonvets.co.uk)



# computing@home

**Friendly local computer expert offers tuition, support, website creation and an I T Helpdesk Service**

**Telephone and remote support available**

**[www.computing-at-home.co.uk](http://www.computing-at-home.co.uk)  
01985 844637**